



BEE OVERSEAS
MOVE WITH PRIDE

ISO 9001:2015
ISO 14001:2015
IATF 16949:2016
ISO 45001:2018



www.beeoverseas.com

Certificate



Certificate of Registration

This is to Certify that
Quality Management System of

BEE OVERSEAS

7/35, ELEPHANTA CHS, GAUSHALA LANE, B L MORARKA MARG,
MALAD EAST, MUMBAI – 400 097, MAHARASHTRA, INDIA

Has been independently assessed and is compliant
with the requirements of
ISO 9001:2015

for the following scope :

MANUFACTURER OF WHEEL HUBS, WHEEL BEARINGS, BRAKE DISC,
ROTOR DISC, RUBBER SPARES FOR AUTOMOTIVE APPLICATION

Certificate No : 23/Q/BE00119

Initial Registration Date : 19/01/2023

Issuance Date : 19/01/2023

Date of Expiry : 18/01/2026

Auth. Signatory



Times Certification Services UK Ltd.

Regd Office : 71-75 Shelton Street, Covent Garden, London, WC2H 9JQ, United Kingdom
This certificate is the Intellectual Property of Times Certification Services UK Ltd. can be maintained through surveillance audit and renewal audit. Certificate shall be returned immediately on request in case of non compliance of Certification Procedure.
Validity of this certificate can be verified at : www.timescert.co.uk or via email at info@timescert.co.uk

Certificate



Certificate of Registration

This is to Certify that
Environmental Management System of

BEE OVERSEAS

7/35, ELEPHANTA CHS, GAUSHALA LANE, B L MORARKA MARG,
MALAD EAST, MUMBAI – 400 097, MAHARASHTRA, INDIA

Has been independently assessed and is compliant
with the requirements of
ISO 14001:2015

for the following scope :

MANUFACTURER OF WHEEL HUBS, WHEEL BEARINGS, BRAKE DISC,
ROTOR DISC, RUBBER SPARES FOR AUTOMOTIVE APPLICATION

Certificate No : 23/E/BE00119

Initial Registration Date : 19/01/2023

Issuance Date : 19/01/2023

Date of Expiry : 18/01/2026

Auth. Signatory



Times Certification Services UK Ltd.

Regd Office : 71-75 Shelton Street, Covent Garden, London, WC2H 9JQ, United Kingdom
This certificate is the Intellectual Property of Times Certification Services UK Ltd. can be maintained through surveillance audit and renewal audit. Certificate shall be returned immediately on request in case of non compliance of Certification Procedure.
Validity of this certificate can be verified at : www.timescert.co.uk or via email at info@timescert.co.uk

Certificate



Certificate of Compliance

This is to certify that
The Quality Management System of

BEE OVERSEAS

7/35, ELEPHANTA CHS, GAUSHALA LANE, B L MORARKA MARG,
MALAD EAST, MUMBAI – 400 097, MAHARASHTRA, INDIA

Has been independently assessed and is compliant
with the requirements of

IATF 16949:2016

for the following scope :

MANUFACTURER OF WHEEL HUBS, WHEEL BEARINGS, BRAKE DISC,
ROTOR DISC, RUBBER SPARES FOR AUTOMOTIVE APPLICATION

Certificate No : 23/CC/BEO0119
Initial Registration Date : 19/01/2023

Issuance Date : 19/01/2023
Date of Expiry : 18/01/2026

Auth. Signatory



Times Certification Services UK Ltd.
Regd Office : 71-75 Shelton Street, Covent Garden, London, WC2H 9JQ, United Kingdom
This certificate is the Intellectual Property of Times Certification Services UK Ltd, can be maintained through surveillance audit and
renewal audit. Certificate shall be returned immediately on request in case of non compliance of Certification Procedure.
Validity of this certificate can be verified at : www.timescert.co.uk or via email at info@timescert.co.uk



Certificate



Certificate of Registration

This is to Certify that
Occupational Health & Safety Management System of

BEE OVERSEAS

7/35, ELEPHANTA CHS, GAUSHALA LANE, B L MORARKA MARG,
MALAD EAST, MUMBAI – 400 097, MAHARASHTRA, INDIA

Has been independently assessed and is compliant
with the requirements of

ISO 45001:2018

for the following scope :

MANUFACTURER OF WHEEL HUBS, WHEEL BEARINGS, BRAKE DISC,
ROTOR DISC, RUBBER SPARES FOR AUTOMOTIVE APPLICATION

Certificate No : 23/O/BEO0119
Initial Registration Date : 19/01/2023

Issuance Date : 19/01/2023
Date of Expiry : 18/01/2026

Auth. Signatory



Times Certification Services UK Ltd.
Regd Office : 71-75 Shelton Street, Covent Garden, London, WC2H 9JQ, United Kingdom
This certificate is the Intellectual Property of Times Certification Services UK Ltd, can be maintained through surveillance audit and
renewal audit. Certificate shall be returned immediately on request in case of non compliance of Certification Procedure.
Validity of this certificate can be verified at : www.timescert.co.uk or via email at info@timescert.co.uk



Introduction

We would like to introduce our self as leading manufacture of Wheel Hubs for Trucks, & Trailers. This company was founded long back in1991. We have experience in last 20 years in this industries. Our manufacturing unit is **Iso 9001:2015** Certified with most modern equipments.

Iso 14001:2015

ISO/TS 16949:2009

OHSAS 18001:2007

Material used for hubs is GGG 60 of best grade. The manufacturing process of hubs includes

- A. Drawings.
- B. Mould Preparation
- C. Filling
- D. Machining
- E. Packing



A. Drawings.

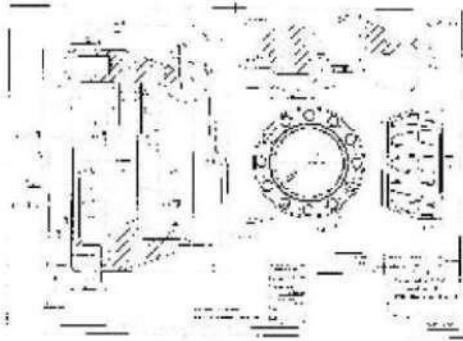

B. Mould Preparation



C. Filling



D. Machining



E. Packing



INDEX

	4 - 13	
	14 - 39	
	40 - 62	
	63 - 64	
		65
	66	
	67	

HUB

	Dimension (mm.)	Dimension (mm.)	Dimension (mm.)
 <p>BEE NO. 7001</p>	<p>A 148 B 148 C 25 D 287 E 381</p>	 <p>BEE NO.7002</p>	 <p>BEE NO.7003</p>
	<p>A 145 B 150 C 25 D 253 E 380</p>	 <p>BEE NO,7004</p>	<p>A 110 B 130 C 22 D 187 E 270</p>
<p>OEM REFERENCES 1391617 1657637</p>	<p>OEM REFERENCES 1275024</p>	<p>OEM REFERENCES 0327227200</p>	<p>OEM REFERENCES 0327230810</p>
<p>BRAND DAF</p>	<p>BRAND DAF</p>	<p>BRAND BPW</p>	<p>BRAND BPW</p>
<p>NEW DEVELOPEMENT</p>	<p>NEW DEVELOPEMENT</p>		

HUB

 <p>Dimension (mm.)</p> <p>A 110</p> <p>B 130</p> <p>C 22</p> <p>D 194</p> <p>E 380</p> <p>BEE NO.7005</p> <p>OEM REFERENCES</p> <p>0327230970</p> <p>0327230950</p> <p>BRAND</p> <p>BPW</p>	 <p>Dimension (mm.)</p> <p>A 130</p> <p>B 170</p> <p>C 22</p> <p>D 223</p> <p>E 380</p> <p>BEE NO.7006</p> <p>OEM REFERENCES</p> <p>0327262270</p> <p>0327262190</p> <p>0327262200</p> <p>BRAND</p> <p>BPW</p>	 <p>Dimension (mm.)</p> <p>A 119.7</p> <p>B 124.7</p> <p>C 25</p> <p>D 208</p> <p>E 386</p> <p>BEE NO.7007</p> <p>OEM REFERENCES</p> <p>0327244210</p> <p>0327244300</p> <p>BRAND</p> <p>BPW</p>	 <p>Dimension (mm.)</p> <p>A 120</p> <p>B 150</p> <p>C 22</p> <p>D 205</p> <p>E 380</p> <p>BEE NO.7008</p> <p>OEM REFERENCES</p> <p>0327248460</p> <p>0327248400</p> <p>BRAND</p> <p>BPW</p>

HUB

 <p>Dimension (mm.)</p> <p>A 120</p> <p>B 150</p> <p>C 22</p> <p>D 207</p> <p>E 380</p> <p>BEE NO.7009</p> <p>OEM REFERENCES 0327243120</p> <p>BRAND BPW</p>	 <p>Dimension (mm.)</p> <p>A -</p> <p>B -</p> <p>C -</p> <p>D -</p> <p>E -</p> <p>BEE NO.7010</p> <p>OEM REFERENCES 0018321c</p> <p>BRAND FRUEHAUF</p>	 <p>Dimension (mm.)</p> <p>A 119.7</p> <p>B 124.7</p> <p>C 25</p> <p>D 208</p> <p>E 386</p> <p>BEE NO..7011</p> <p>OEM REFERENCES Ajb 0038001</p> <p>BRAND FRUEHAUF</p>	 <p>Dimension (mm.)</p> <p>A 157</p> <p>B 170</p> <p>C 22</p> <p>D 220</p> <p>E 375</p> <p>BEE NO.7012</p> <p>OEM REFERENCES 3463562901 9423561701</p> <p>BRAND MERCEDES</p>
---	---	--	---

HUB

 <p>BEE NO.7013</p> <p>OEM REFERENCES 3553563601</p> <p>BRAND MERCEDES</p>	 <p>BEE NO.7014</p> <p>OEM REFERENCES 3563560001</p> <p>BRAND MERCEDES</p>	 <p>BEE NO.7015</p> <p>OEM REFERENCES 3853561301</p> <p>BRAND MERCEDES</p>	 <p>BEE NO.7016</p> <p>OEM REFERENCES 9423341201 9423340701 9423340201</p> <p>BRAND MERCEDES</p>
<p>Dimension (mm.)</p> <p>A 145</p> <p>B 160</p> <p>C 22</p> <p>D 210</p> <p>E 375</p>	<p>Dimension (mm.)</p> <p>A 140</p> <p>B 150</p> <p>C 22</p> <p>D 276</p> <p>E 382</p>	<p>Dimension (mm.)</p> <p>A 119.7</p> <p>B 124.7</p> <p>C 25</p> <p>D 208</p> <p>E 386</p>	<p>Dimension (mm.)</p> <p>A 157</p> <p>B 170</p> <p>C 22</p> <p>D 220</p> <p>E 375</p>

HUB

 <p>BEE NO.7017</p> <p>Dimension (mm.)</p> <p>A 110 B 130 C 12 D 148 E 168</p> <p>OEM REFERENCES 9753300425</p> <p>BRAND MERCEDES</p>	 <p>BEE NO.7018</p> <p>Dimension (mm.)</p> <p>A 120 B 147 C 22 D 181.5 E 384</p> <p>OEM REFERENCES 2307104200</p> <p>BRAND SAF-SAUER</p>	 <p>BEE NO.7019</p> <p>Dimension (mm.)</p> <p>A 120 B 147 C 22 D 184.5 E 384</p> <p>OEM REFERENCES 3307115900</p> <p>BRAND SAF-SAUER</p>	 <p>BEE NO.7020</p> <p>Dimension (mm.)</p> <p>A 120 B 147 C 22 D 184 E 270</p> <p>OEM REFERENCES 3307205600</p> <p>BRAND SAF-SAUER</p>
--	---	---	---

HUB

 <p>BEE NO.7021</p> <p>OEM REFERENCES 33073000600</p> <p>BRAND SAF-SAUER</p>	 <p>BEE NO.7022</p> <p>OEM REFERENCES 1414154</p> <p>BRAND SCANIA</p>	 <p>BEE NO.7023</p> <p>OEM REFERENCES 1724788</p> <p>BRAND SCANIA</p>	 <p>BEE NO.7024</p> <p>OEM REFERENCES 1724790 1800283</p> <p>BRAND SCANIA</p>
<p>Dimension (mm.)</p> <p>A 175</p> <p>B 175</p> <p>C 22</p> <p>D 124</p> <p>E 385</p>	<p>Dimension (mm.)</p> <p>A 120</p> <p>B 147</p> <p>C 22</p> <p>D 181.5</p> <p>E 384</p>	<p>Dimension (mm.)</p> <p>A 120</p> <p>B 147</p> <p>C 22</p> <p>D 184.5</p> <p>E 384</p>	<p>Dimension (mm.)</p> <p>A 120</p> <p>B 147</p> <p>C 22</p> <p>D 184</p> <p>E 270</p>

HUB

 <p>BEE NO.7025</p> <p>Dimension (mm.)</p> <p>A 147</p> <p>B 147</p> <p>C 22.25</p> <p>D 210.5</p> <p>E 380</p> <p>OEM REFERENCES</p> <p>1382884</p> <p>BRAND</p> <p>SCANIA</p>	 <p>BEE NO.7026</p> <p>Dimension (mm.)</p> <p>A 150</p> <p>B 160</p> <p>C 25</p> <p>D 243</p> <p>E 376.5</p> <p>OEM REFERENCES</p> <p>5010566112</p> <p>BRAND</p> <p>RENAULT</p>	 <p>BEE NO.7027</p> <p>Dimension (mm.)</p> <p>A -</p> <p>B 134</p> <p>C 23</p> <p>D 180</p> <p>E 377</p> <p>OEM REFERENCES</p> <p>14219784</p> <p>BRAND</p> <p>ROR - MERITOR</p>	 <p>BEE NO.7028</p> <p>Dimension (mm.)</p> <p>A 140</p> <p>B 140</p> <p>C 23</p> <p>D 158</p> <p>E 377</p> <p>OEM REFERENCES</p> <p>14225425</p> <p>BRAND</p> <p>ROR - MERITOR</p>
--	---	---	---

HUB

			
<p>Dimension (mm.)</p> <p>A 150</p> <p>B 152</p> <p>C 23</p> <p>D 175</p> <p>E 365</p>	<p>Dimension (mm.)</p> <p>A 120</p> <p>B 147</p> <p>C 22.7</p> <p>D 178</p> <p>E 271</p>	<p>Dimension (mm.)</p> <p>A 120</p> <p>B 147</p> <p>C 22.7</p> <p>D 178</p> <p>E 380</p>	<p>Dimension (mm.)</p> <p>A 130</p> <p>B 145</p> <p>C 25.5</p> <p>D 172</p> <p>E 371.5</p>
<p>BEE NO.7029</p> <p>OEM REFERENCES</p> <p>14226121</p> <p>BRAND</p> <p>ROR - MERITOR</p>	<p>BEE NO.7030</p> <p>OEM REFERENCES</p> <p>21203219</p> <p>BRAND</p> <p>ROR - MERITOR</p>	<p>BEE NO.7031</p> <p>OEM REFERENCES</p> <p>21204561</p> <p>21204562</p> <p>14204561</p> <p>14204562</p> <p>BRAND</p> <p>ROR - MERITOR</p>	<p>BEE NO.7032</p> <p>OEM REFERENCES</p> <p>6502795 d</p> <p>0018321 c</p> <p>BRAND</p> <p>TRAILOR</p>

HUB

 <p>BEE NO.7033</p> <p>Dimension (mm.)</p> <p>A 113 B 130 C 27.15 D 205 E 383</p> <p>OEM REFERENCES</p> <p>1626994 20374418</p> <p>BRAND VOLVO</p>	 <p>BEE NO.7034</p> <p>Dimension (mm.)</p> <p>A 148 B 148 C 27 D 157 E 385</p> <p>OEM REFERENCES</p> <p>20517164</p> <p>BRAND VOLVO</p>	 <p>BEE NO.7035</p> <p>Dimension (mm.)</p> <p>A 148 B 148 C 27 D 172.5 E -</p> <p>OEM REFERENCES</p> <p>20517952 85104299 3988774</p> <p>BRAND VOLVO</p>	 <p>BEE NO.7036</p> <p>Dimension (mm.)</p> <p>A 125 B 125 C 25 D 219.5 E 384</p> <p>OEM REFERENCES</p> <p>20518092 21024160 21024166</p> <p>BRAND VOLVO</p>
---	--	---	--

HUB



BEE NO.7037

**Dimension
(mm.)**

A
148
B
148
C
25.25
D
157
E
385

OEM REFERENCES

20820402

BRAND

VOLVO



BEE NO.7038

**Dimension
(mm.)**

A
148
B
148
C
25
D
226
E
383

OEM REFERENCES

851007752

BRAND

VOLVO



BEE NO.7039

**Dimension
(mm.)**

A
120
B
147
C
22.7
D
178
E
380

OEM REFERENCES

20517164-1

BRAND

VOLVO



BEE NO.7040

**Dimension
(mm.)**

A
--
B
--
C
--
D
--
E
--

OEM REFERENCES

85114470

BRAND

VOLVO

WHEEL BEARING

OEM Ref.	Cross Ref.	Application	Weight	Dimension (mm.)
1075408	FAG -	DAF	5.2 kg.	93 ID
20517952	566425	RENAULT		148 OD
20518661	.H 195	VOLVO		135 H.
20535231				
21036050				
20792349				
7420792439				
3988774				

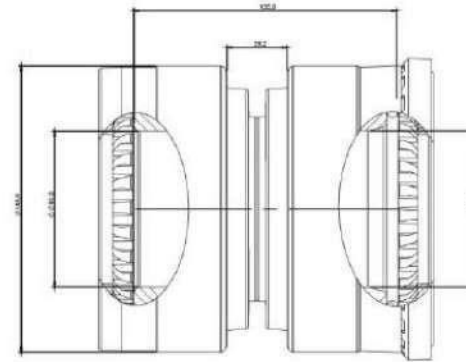

BEE NO.7041

OEM Ref.	Cross Ref.	Application	Weight	Dimension (mm.)
1691621	FAG -	DAF	5 kg.	70 ID
1801592	566074			131 OD
	.H 195			114 H.

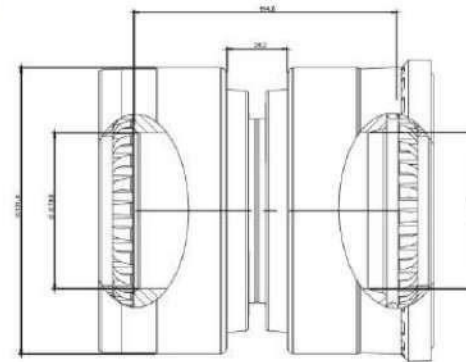

BEE NO.7042

WHEEL BEARING

OEM Ref.	Cross Ref.	Application	Weight	Dimension (mm.)
1391615	FAG - 566834. H195	DAF	4.2 kg.	70 ID 124 OD 110 H.

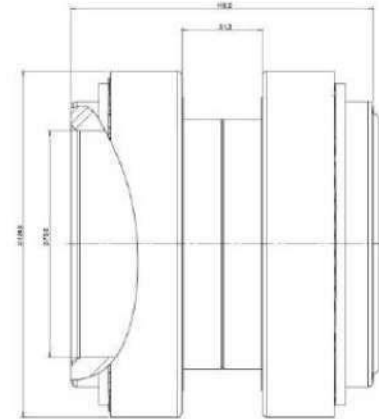

BEE NO.7043

OEM Ref.	Cross Ref.	Application	Weight	Dimension (mm.)
1391617	FAG - 566283. H195	DAF	6.2 kg.	59 ID 17 OD 6 H.



BEE NO.7044

WHEEL BEARING

OEM Ref.	Cross Ref.	Application	Weight	Dimension (mm.)
1613331	FAG - 566193 H195	DAF	5.9 kg.	18 ID 59 OD 7 H.

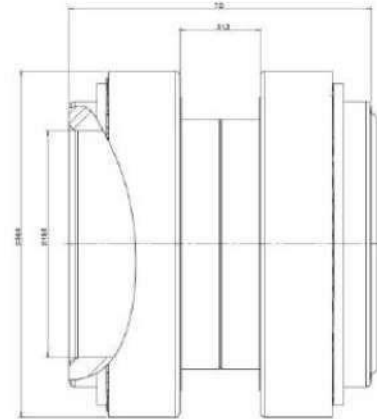

BEE NO.7045

OEM Ref.	Cross Ref.	Application	Weight	Dimension (mm.)
Used For Front Hub 1391615	FAG 805051	DAF	4 kg.	70 ID 124 OD 110 H.

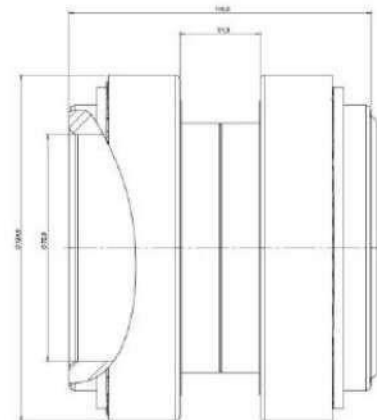

BEE NO.7046

WHEEL BEARING

OEM Ref.	Cross Ref.	Application	Weight	Dimension (mm.)
Used For	FAG -	DAF	5.9 kg.	148 ID
Rear Hub	805052			100 OD
1391617	805208			135 H.

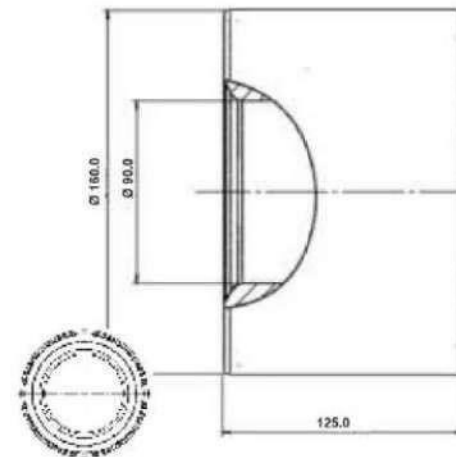

BEE NO.7047

OEM Ref.	Cross Ref.	Application	Weight	Dimension (mm.)
1905487	FAG -	IVECO	10.6 kg.	90 ID
2996882	201059			160 OD
7179751	805012.06			125 H.
7183074	H. 195			
7183075	SKF			
7189050	BTH 0053			
7189648	VKBA			
	5397			

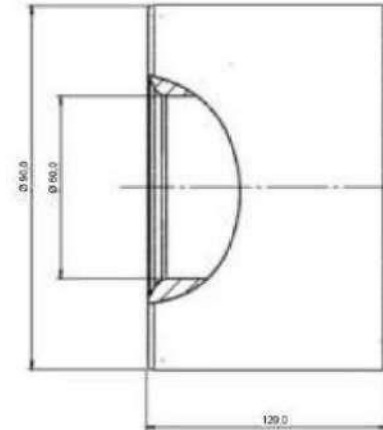

BEE NO.7048

WHEEL BEARING

OEM Ref.	Cross Ref.	Application	Weight	Dimension (mm.)
42537774	FAG -	IVECO	-. kg.	90 ID
42539148	201072			60 OD
	VKBA			125 H.
	5413			

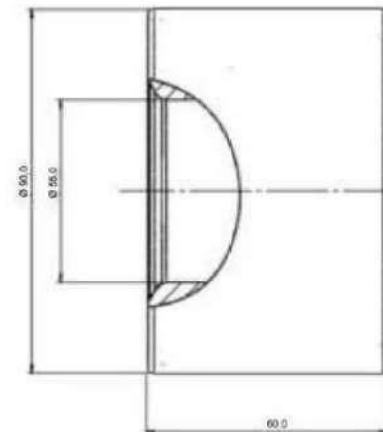

BEE NO.7049

OEM Ref.	Cross Ref.	Application	Weight	Dimension (mm.)
7180066	FAG -	IVECO	1.5 kg.	55 ID
	713690840			90 OD
	SKF			60 H.
	BTH 1011			
	VKBA			
	3552			

BEE NO.7050

WHEEL BEARING

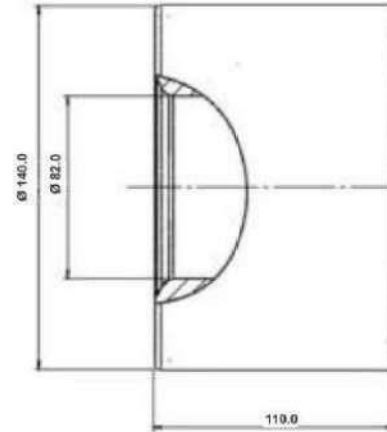
OEM Ref.	Cross Ref.	Application	Weight	Dimension (mm.)
2994058	FAG -	IVECO	6.4 kg.	82 ID
7184079	805011C	MERITOR		140 OD
7184080	VKBA 5409	(ROR)		110 H.



BEE NO.7051

OEM Ref.	Cross Ref.	Application	Weight	Dimension (mm.)
85103257	FAG - 805092 C	IVECO MAN	4.4 kg.	77 ID
				130 OD
				91 H.

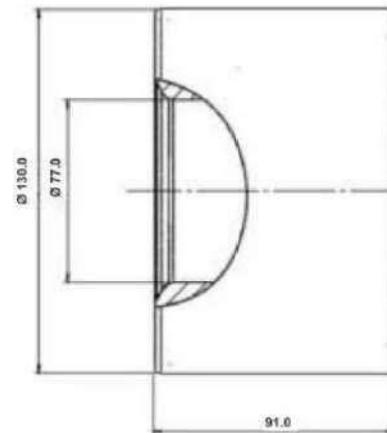

BEE NO.7052

WHEEL BEARING

OEM Ref.	Cross Ref.	Application	Weight	Dimension (mm.)
93810034	FAG - 713690850 SKF VKBA 3553	IVECO	-	45 ID 120 OD 85 H.

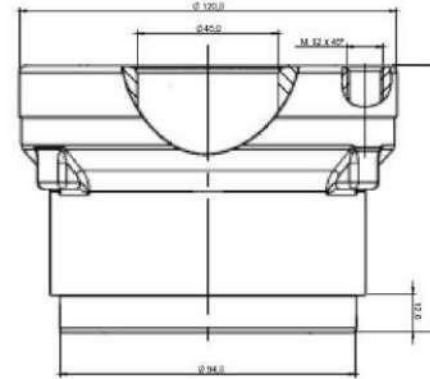

BEE NO.7053

OEM Ref.	Cross Ref.	Application	Weight	Dimension (mm.)
81.93420- 0346	FAG - 804162 A VKBA 5416	MAN	8.650 kg.	110 ID 170 OD 146 H.

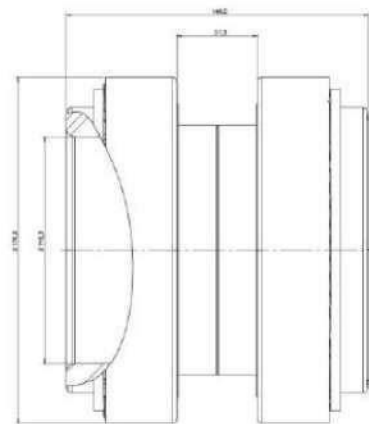

BEE NO.7054

WHEEL BEARING

OEM Ref.	Cross Ref.	Application	Weight	Dimension (mm.)
5010216920	FAG - 201044 SKF VKBA 5308	MAN IEVCO	-	70 ID 196 OD 140 H.

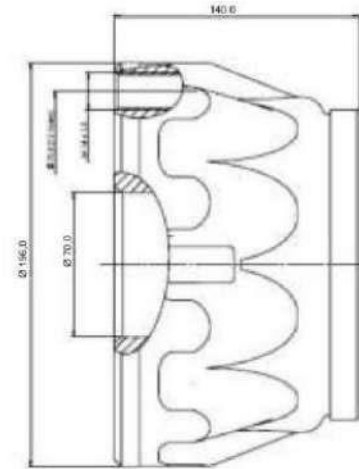

BEE NO.7055

OEM Ref.	Cross Ref.	Application	Weight	Dimension (mm.)
81.93420-0320 81.93420-0342 14013817	FAG - 803750 B	MAN	7 kg.	60 ID 130 OD 32.2 H.



BEE NO.7056

WHEEL BEARING

OEM Ref.	Cross Ref.	Application	Weight	Dimension (mm.)
81934200337	FAG 201082 SKF VKBA 5411	MAN	8 kg.	60 ID 18 OD 6.5 H.



BEE NO.7057

OEM Ref.	Cross Ref.	Application	Weight	Dimension (mm.)
06369590030	SKF - BLAB 366485 C	MAN	1.3 kg.	25 ID 48 OD 16 H.



BEE NO.7058

WHEEL BEARING

OEM Ref.	Cross Ref.	Application	Weight	Dimension (mm.)
81934200330	FAG	MAN	7.8 kg.	70 ID
81934200288	801974AE			196 OD
81934200349	.H195			40 H.



BEE NO.7059

OEM Ref.	Cross Ref.	Application	Weight	Dimension (mm.)
81934200330	SKF	MAN	8 kg.	93.80 ID
81934200288	VKBA			94 OD
	5377			135/148 H.
	BTF			
	0110			



BEE NO.7060

WHEEL BEARING

OEM Ref.	Cross Ref.	Application	Weight	Dimension (mm.)
06324890072	SKF	MAN	1.1 kg.	40ID
06324890073	BT1B328251			90 OD
	VBHB			120 H.
	2240			



BEE NO.7061

OEM Ref.	Cross Ref.	Application	Weight	Dimension (mm.)
0139812206	FAG -	MERCEDES	4.2 kg.	78 ID
0139812305	803194A			130 OD
0139819805				90 H.

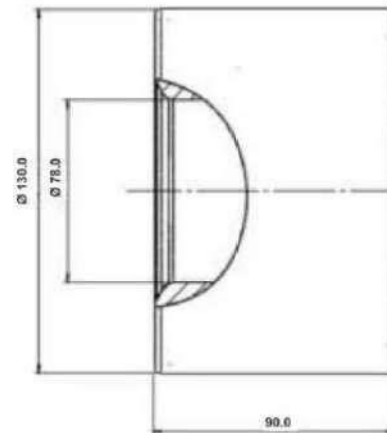

BEE NO.7062

WHEEL BEARING

OEM Ref.	Cross Ref.	Application	Weight	Dimension (mm.)
159811905	FAG - 201050	MERCEDES VOLVO	2.7 kg.	60 ID 108 OD 75 H.

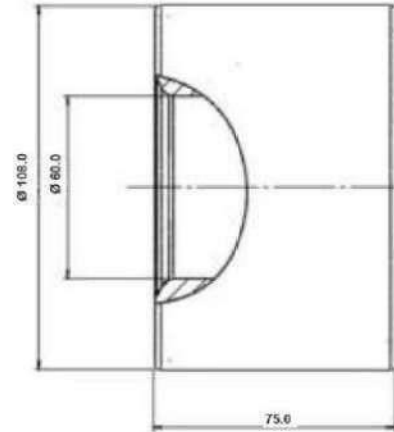

BEE NO.7063

OEM Ref.	Cross Ref.	Application	Weight	Dimension (mm.)
0149815105	FAG -	MERCEDES	6.5 kg.	82 ID
0149819305	805003			140 OD
0149819905	A.H.195			115 H.
0179815005	SKF			
	BTH 0022			
	VKBA			
	5412			

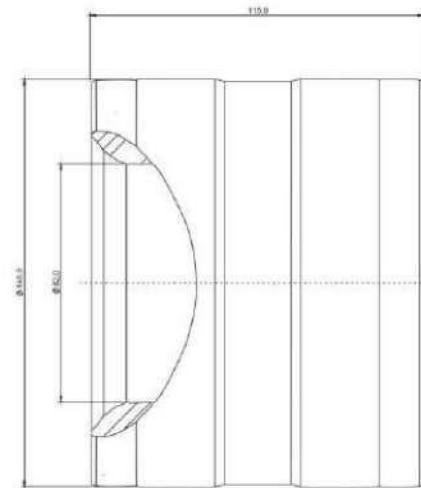

BEE NO.7064

WHEEL BEARING

OEM Ref.	Cross Ref.	Application	Weight	Dimension (mm.)
503126457	FAG -	MERCEDES	6.9 kg.	105 ID
81.93420-0320 / 0342	803750 B	MAN VOLVO		160 OD 140 H.

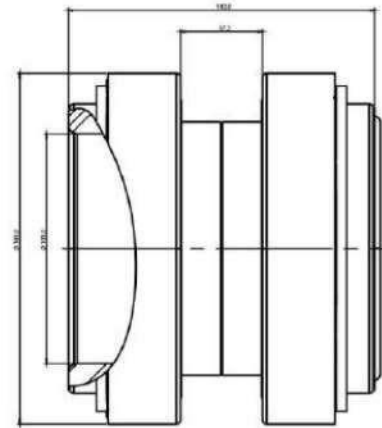

BEE NO.7065

OEM Ref.	Cross Ref.	Application	Weight	Dimension (mm.)
7220634100	FAG -	MERCEDES	4.1 kg.	65 ID
	801794 B			152 OD 48 H.



BEE NO.7066

WHEEL BEARING

OEM Ref.	Cross Ref.	Application	Weight	Dimension (mm.)
0089813205	FAG -	MERCEDES	1.1 kg.	75 ID
0089814605	580616			140 OD
				36.25 H.



BEE NO.7067

OEM Ref.	Cross Ref.	Application	Weight	Dimension (mm.)
-	FAG -	MERCEDES	0.9 kg.	59.6 ID
	572813			17.8 OD
	SKF			6.6 H.
	BT 10084Q			
	VKBA			
	2280			



BEE NO.7068

WHEEL BEARING

OEM Ref.	Cross Ref.	Application	Weight	Dimension (mm.)
0089813205	FAG -	MERCEDES	1.1 kg.	75 ID
0089814605	580616			140 OD 36.25 H.

BEE NO.7069

OEM Ref.	Cross Ref.	Application	Weight	Dimension (mm.)
5010216920	FAG -	RENAULT	-	65 ID
7420879770	201044			194 OD
	SKF			113 H.
	VKBA			
	5308			

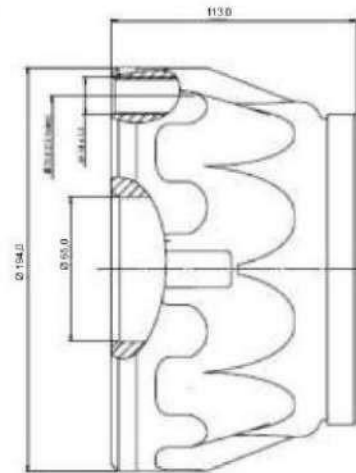
BEE NO.7070

WHEEL BEARING

OEM Ref.	Cross Ref.	Application	Weight	Dimension (mm.)
5010439770	FAG - 201043	RENAULT	-	70 ID 194 OD 112 H.



BEE NO.7071

OEM Ref.	Cross Ref.	Application	Weight	Dimension (mm.)
5010566154	FAG - 201042	RENAULT	-	50 ID 140 OD - H.



BEE NO.7072

WHEEL BEARING

OEM Ref.	Cross Ref.	Application	Weight	Dimension (mm.)
20382168	FAG -	RENAULT	4.4 kg.	68 ID
20518092	566426	VOLVO		125 OD
20518637	.H 195			115 H.
20558950				
20728008				
21021391				
3988675				

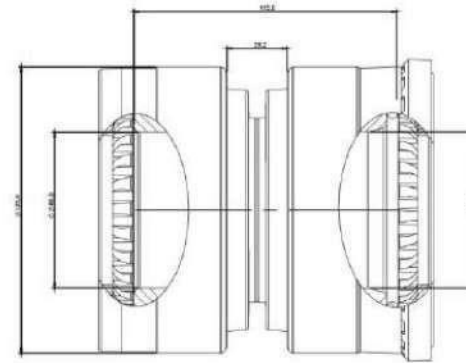

BEE NO.7073

OEM Ref.	Cross Ref.	Application	Weight	Dimension (mm.)
20550678	FAG -	RENAULT	-	60 ID
5010587029	805532			168 OD
				100 H.

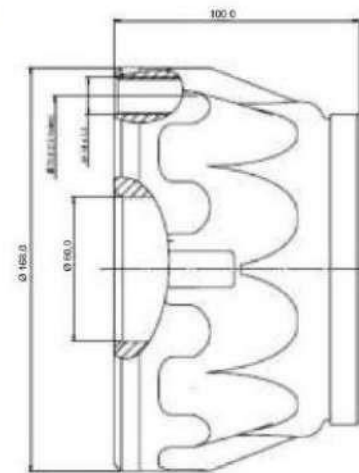

BEE NO.7074

WHEEL BEARING

OEM Ref.	Cross Ref.	Application	Weight	Dimension (mm.)
-	SKF VKBA 2315	RENAULT	1 kg.	596.0 ID 175.0 OD 66.0 H.



BEE NO.7075

OEM Ref.	Cross Ref.	Application	Weight	Dimension (mm.)
20550678 5010587029	FAG - 805532	RENAULT	-	60 ID 168 OD 100 H.

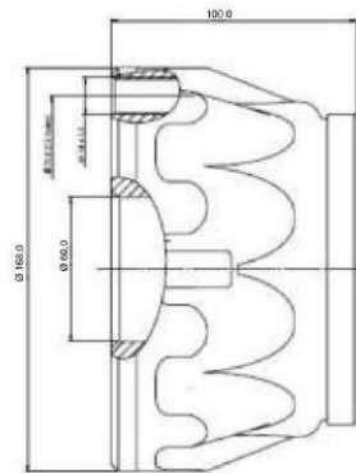

BEE NO.7076

WHEEL BEARING

OEM Ref.	Cross Ref.	Application	Weight	Dimension (mm.)
20518617	FAG -	RVI	5.6 kg.	58 ID
20967830	566427	VOLVO		110 OD
20589393	.H 195			115 H.
20589394	SKF			
7420518617	VKBA			
7421021381	5424			

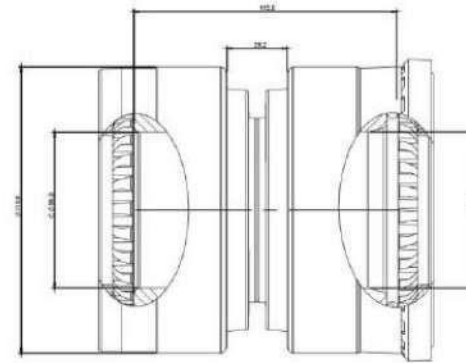

BEE NO.7077

OEM Ref.	Cross Ref.	Application	Weight	Dimension (mm.)
USED FOR HUB	FAG - 805531	RVI	3.9 kg.	60 ID
5010566154				168 OD
5010308616				102 H.



BEE NO.7078

WHEEL BEARING

OEM Ref.	Cross Ref.	Application	Weight	Dimension (mm.)
5010308616	FAG	RVI	6.9 kg.	60 ID
5010566154	805531			168 OD
	805165 A			102 H.
	SKF			
	VKBA			
	5407			
	BTF			
	068			

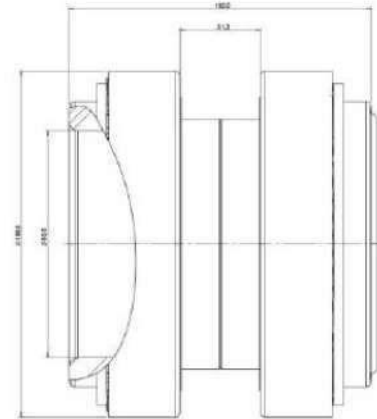

BEE NO.7079

OEM Ref.	Cross Ref.	Application	Weight	Dimension (mm.)
1002689	FAG -	SAF	15.6 kg.	82 ID
1003457	564734			196 OD
100167601	.H195			110 H.
3200200151				
4200200100				
4200200101				

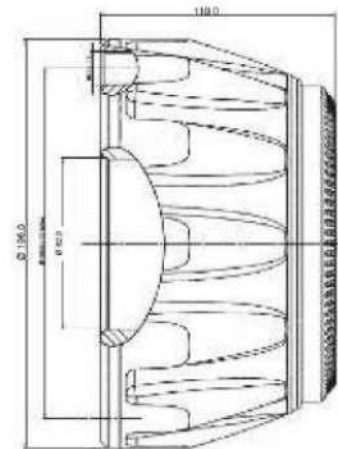

BEE NO.7080

WHEEL BEARING

OEM Ref.	Cross Ref.	Application	Weight	Dimension (mm.)
03434301200	FAG -	SAF	6.9 kg.	120 ID
42001016602	803904			175 OD
				123 H.

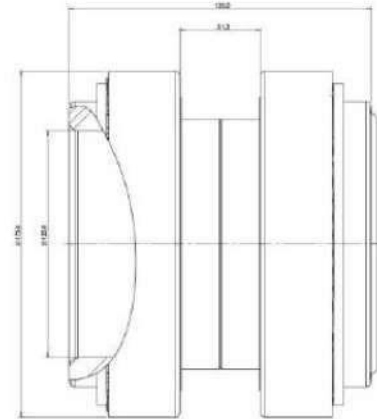

BEE NO.7081

OEM Ref.	Cross Ref.	Application	Weight	Dimension (mm.)
3307303000	FAG -	SAF	5.0 kg.	68 ID
3307303001	805479			127/132 OD
				115 H.



BEE NO.7082

WHEEL BEARING

OEM Ref.	Cross Ref.	Application	Weight	Dimension (mm.)
3434301900	FAG - 808918	SAF	5 kg.	- ID -- OD -- H.



BEE NO.7083

OEM Ref.	Cross Ref.	Application	Weight	Dimension (mm.)
42001016602	FAG	SAF	6.4 kg.	82 ID
03434301200	566830. H 195			140 OD 115 H.

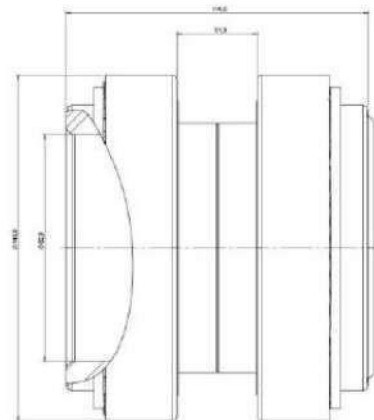

BEE NO.7084

WHEEL BEARING

OEM Ref.	Cross Ref.	Application	Weight	Dimension (mm.)
4200101500	FAG - 800308 579065 D	SAF	5.2 kg.	82 ID 138 OD 110 H.

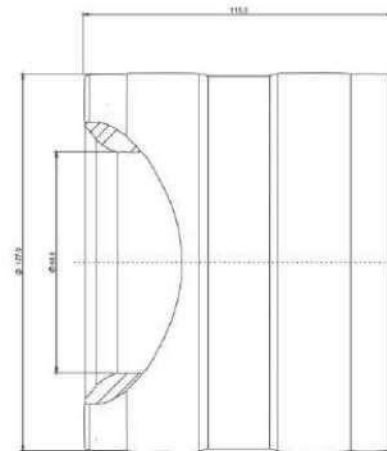

BEE NO.7085

OEM Ref.	Cross Ref.	Application	Weight	Dimension (mm.)
01413785	FAG -	SCANIA	6.2 kg.	68 ID
01439070	57162.H.195			127 OD
01443078	SKF			115 H.
01476945	BTH 0018			
01724482	AVKBA5314			
01868087				

BEE NO.7086

WHEEL BEARING

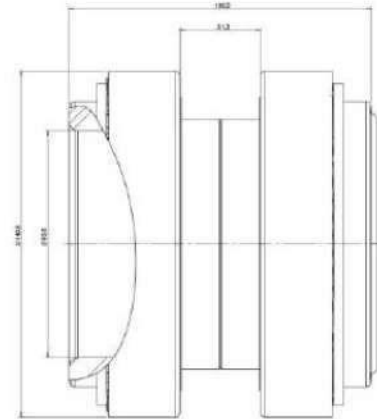
OEM Ref.	Cross Ref.	Application	Weight	Dimension (mm.)
1075408	FAG -	VOLVO	6.1 kg.	93 ID
3988774	800792 D			140 OD
20517952				135 H.
20518661				
20535231				
20558966				
20792439				
20792440				



BEE NO.7087

OEM Ref.	Cross Ref.	Application	Weight	Dimension (mm.)
20367197	FAG -	VOLVO	3.5 kg.	90 ID
20392010	805165			110 OD
20367196				- H.

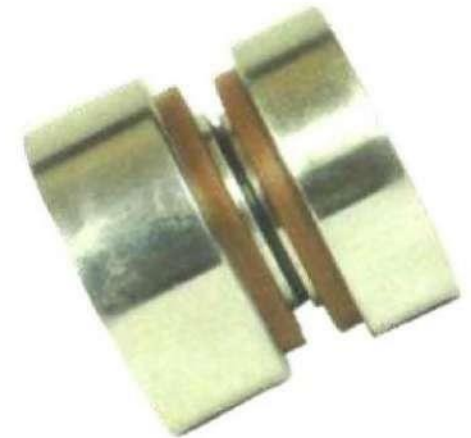
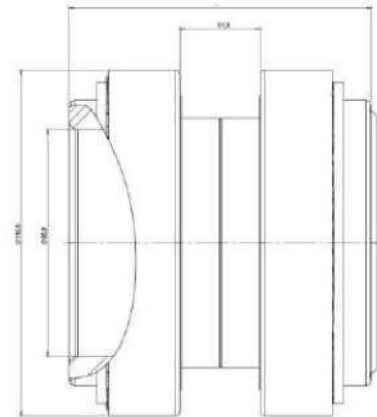

BEE NO.7088

WHEEL BEARING

OEM Ref.	Cross Ref.	Application	Weight	Dimension (mm.)
1075408	FAG -	VOLVO	5.0 kg.	68.2 ID
20792439	581079 C			125 OD
20484350				115 H.
20518661				



BEE NO.7089

OEM Ref.	Cross Ref.	Application	Weight	Dimension (mm.)
20518637	FAG -	VOLVO	5.9 kg.	93.5 ID
20558950	800792			94 OD
				148/135 H.



BEE NO.7090

WHEEL BEARING

OEM Ref.	Cross Ref.	Application	Weight	Dimension (mm.)
BT 10097	BT 10097	Volvo	2.1 kg.	40 ID 90 OD 120 H.

**BEE NO.7091**

CLUTCH BEARING

SACHS Ref. : 3151 182 233 - 3151 182 106
DAF : 133 43 50 , 128 78 06
BEE NO : 7092



SACHS Ref. : 3151 274 831 - 3151 057 001
DAF : 130 38 21
BEE NO : 7093



SACHS Ref. : 3151 153 002 - 3151 199 001
DAF : 514454 - 659320
BEE NO : 7094



SACHS Ref. : 3151 023 101 - 1851 117 201
DAF : 658418, 658428
BEE NO : 7095



SACHS Ref. : -
DAF : 659320
BEE NO : 7096



SACHS Ref. : 3151 152 102 - 3151 152 101
DAF : 126 16 52, 130 38 21
BEE NO : 7097

CLUTCH BEARING



SACHS Ref. : 3151 169 332 - 3151 273 431
DAF : 125 07 10 , 130 39 75
BEE NO : **7098**



SACHS Ref. : 3151 007 303 - 3151 51 101 031
DAF : 113 36 5
BEE NO : **7099**



SACHS Ref. : 3151 273 731 - 3151 000 335
DAF : 114 21 88
BEE NO : **7100**



SACHS Ref. : 3151 225 001 - 3151 203 031
DAF : 161 59 27, 163 46 27
BEE NO : **7101**



SACHS Ref. : 3151 263 031
DAF : 130 37 07, 131 14 97
BEE NO : **7102**



SACHS Ref. : 3151 000 157
DAF : 166 43 58
BEE NO : **7103**

CLUTCH BEARING



SACHS Ref. : 3151 000 493

DAF : 168 66 42, 182 06 61R, 1746150

BEE NO : 7104



SACHS Ref. : 3151 225 031 - 3151 203 031

IVECO : 0190 47 56, 421 04 476

BEE NO : 7105



SACHS Ref. : 3151 117 031.

IVECO : 477 02 05, 0477 02 05

BEE NO : 7106



SACHS Ref. : 3151 007 303 - 3151 101 031

IVECO : 42063184, 358511, 42003473

BEE NO : 7107



SACHS Ref. : 3151 054 032

IVECO : 04702806

BEE NO : 7108



SACHS Ref. : 3151 274 831 - 3151 157 001

IVECO : 0220924, 03428017, 42003823

BEE NO : 7109

CLUTCH BEARING



SACHS Ref. : 3151 153 002 - 3151 015 301
IVECO : 42061921, 02475546, 02475547
BEE NO : **7110**



SACHS Ref. : 1851 117 201
IVECO : 04774151, 01261558, 01398598
BEE NO : **7111**



SACHS Ref. : 3100 002 038 - 3151 123 031
IVECO : 0819332, 04742138, 42062095
BEE NO : **7112**



SACHS Ref. : 3151 225 031 - 3151 203 031
IVECO : 01904779, 500305439, 42114856
BEE NO : **7113**



SACHS Ref. : -
IVECO : 5921 01 60
BEE NO : **7114**



SACHS Ref. : -
IVECO : 460 51 81
BEE NO : **7115**

CLUTCH BEARING

SACHS Ref. : 3151 225 001 - 3151 000 144
IVECO : 01904756, 504146901, 2992486
BEE NO : **7116**



SACHS Ref. : 3151 272 631 - 3151 211 031
IVECO : 713 89 64
BEE NO : **7117**



SACHS Ref. : 3482 907 001
IVECO : 190 38 41, 9380.1297, 9380.8508
BEE NO : **7118**



SACHS Ref. : 3151 169 332 - 3151 169 031
MAN : 81.30550.0087, 81.30550.0067
BEE NO : **7119**



SACHS Ref. : 3151 152 102 - 3151 000 395
MAN : 81.30550.0069, 81.30550.78
BEE NO : **7120**



SACHS Ref. : 3151 067 032 - 3151 067 002
MAN : 81.30550.0056
BEE NO : **7121**

CLUTCH BEARING



SACHS Ref. : 3151 067 031 - 3151 067 001

MAN : 81.30550.0054, 81.30550.0043

BEE NO : 7122



SACHS Ref. : 3151 183 041

MAN : -

BEE NO : 7123



SACHS Ref. : 3151 066 032 - 3151 000 395

MAN : 81.30550.0050

BEE NO : 7124



SACHS Ref. : 3151 066 001

MAN : -

BEE NO : 7125



SACHS Ref. : 3151 007 303 - 3151 101 031

MAN : 81.30550.0035, 81.30550.0049

BEE NO : 7126



SACHS Ref. : 3151 274 831 - 3151 057 001

MAN : 81.30550.0026, 81.30550.0072

BEE NO : 7127

CLUTCH BEARING



SACHS Ref. : 3151 153 002 - 3151 199 001
MAN : 81.30550.0044, 81.30550.0060
BEE NO : 7128



SACHS Ref. : 3151 023 101 - 1851 117 201
MAN : 81.30550.0041, 81.30550.6019
BEE NO : 7129



SACHS Ref. : 3151 280 601 - 3151 000 053
MAN : 81 305 50 0109, 81 305 50 0110
BEE NO : 7130



SACHS Ref. : 3151 225 001 - 3151 203 031
MAN : 81.30550.0101, 81.30550.0102
BEE NO : 7131



SACHS Ref. : 3151 153 002 - 3151 199 002
MAN : 81.30550.0044, 81.30550.0060
BEE NO : 7132



SACHS Ref. : 3151 262 031
MAN : 81.30550.7220, 81.30550.0085
BEE NO : 7133

CLUTCH BEARING

SACHS Ref. : 3151 253 031

MAN : 81.30550.0082

BEE NO : 7134



SACHS Ref. : 3151 263 031

MAN : 81.305.500.080,81.305.500.089

BEE NO : 7135



SACHS Ref. : 3151 000 157

MAN : 36.305.500.003

BEE NO : 7136



SACHS Ref. : 3151 000 493

MAN : 81.30550.0249, 81.30550.0252

BEE NO : 7137



SACHS Ref. : 3151 246 031 - 3151 602 004

MERCEDES : 0012507915, 0012500515

BEE NO : 7138



SACHS Ref. : 3151 245 031 - 3151 241 031

MERCEDES : 12508815, 12500615, 12508015

BEE NO : 7139

CLUTCH BEARING



SACHS Ref. : 3151 170 131 - 3151 602 005
MERCEDES : 0012500815, 0002509515
BEE NO : 7140



SACHS Ref. : 3151 110 031
MERCEDES : 0002507315
BEE NO : 7141



SACHS Ref. : 3151 043 032
MERCEDES : 0002506415
BEE NO : 7142



SACHS Ref. : 3151 027 131 - 3151 602 002
MERCEDES : 0002501915, 0002507415
BEE NO : 7143



SACHS Ref. : 3151 126 031
MERCEDES : 0002507615
BEE NO : 7144



SACHS Ref. : 3151 108 031
MERCEDES : 0002507515
BEE NO : 7145

CLUTCH BEARING

SACHS Ref. : 3151 272 631 - 3151 211 031

MERCEDES : 0012502215

BEE NO : 7146



SACHS Ref. : 3151 112 031

MERCEDES : 0002507015

BEE NO : 7147



SACHS Ref. : 3151 094 041

MERCEDES : 327250115, 3052500615

BEE NO : 7148



SACHS Ref. : 3151 087 041 - 3151 602 001

MERCEDES : 3202500015, 3432540010

BEE NO : 7149



SACHS Ref. : 3151 051 031 - 3151 051 001

MERCEDES : 0002504415

BEE NO : 7150



SACHS Ref. : 3151 033 031

MERCEDES : 0002503715, 0002501715

BEE NO : 7151

CLUTCH BEARING



SACHS Ref. : 3151 602 003
MERCEDES : 0012509315, 0012504615
BEE NO : 7152



SACHS Ref. : 3151 000 020
MERCEDES : A6842504015
BEE NO : 7153



SACHS Ref. : 3151 000 155, 3151 259 031
MERCEDES : 0022506715, 0022507815
BEE NO : 7154



SACHS Ref. : 3100 000 003 - 3100 002 254
MERCEDES : 0022508215, 0022507715
BEE NO : 7155



SACHS Ref. : 3151 000 157 - 3151 195 033
MERCEDES : 002 250 45 15
BEE NO : 7156



SACHS Ref. : 3151 245 031 - 3151 241 031
MERCEDES : 0012506715, 0012508815
BEE NO : 7157

CLUTCH BEARING



SACHS Ref. : 3151 245 032 - 3151 184 032
MERCEDES : 0012508415, 0012506315
BEE NO : 7158



SACHS Ref. : 3151 000 335 - 3151 273 731
MERCEDES : 0022504915, 0022504415
BEE NO : 7159



SACHS Ref. : 3151 095 043
MERCEDES : 3522500115, 3402500215
BEE NO : 7160



SACHS Ref. : 3151 095 043
MERCEDES : 3522500110
BEE-NO : 7161



SACHS Ref. : 3100 002 258 - 3151 000 254
MERCEDES : 0022504215
BEE NO : 7162



SACHS Ref. : 3151 043 031
MERCEDES : 0002503815, 0002503615
BEE NO : 7163

CLUTCH BEARING



SACHS Ref. : 34 3151 260 001

MERCEDES : 002 250 35 15

BEE NO : 7164



SACHS Ref. : 3151 225 031 - 3151 203 031

MERCEDES : 0002543008

BEE NO : 7165



SACHS Ref. : 3151 027 102

MERCEDES :

BEE NO : 7166



SACHS Ref. : 3151 000 157

MERCEDES : 0022508815, 0032501515

BEE NO : 7167



SACHS Ref. : 3151 000 493

MERCEDES : 0002543208

BEE NO : 7168



SACHS Ref. : 3151 028043

MERCEDES : 0002540220

BEE NO : 7169

CLUTCH BEARING



SACHS Ref. : 3151 166 031
RENAULT : 000 250 92 15
BEE NO : 7170



SACHS Ref. : 3151 150 041
RENAULT : 0023618122, 5000821330
BEE NO : 7171



SACHS Ref. : 3151 067 032
RENAULT : 5000807806
BEE NO : 7172



SACHS Ref. : 3151 067 031 - 3151 067 001
RENAULT : 81.30550.0043, 81.3000.6336
BEE NO : 7173



SACHS Ref. : 3151 007 303
RENAULT : 0001141035
BEE NO : 7174



SACHS Ref. : 3151 274 831 - 3151 057 001
RENAULT : 5000251362
BEE NO : 7175

CLUTCH BEARING



SACHS Ref. : 3151 153 001 - 3151 199 002
RENAULT : 5000240864, 5000r09155
BEE NO : 7176



SACHS Ref. : 1851 117 201 - 3151 157 001
RENAULT : 5000456367
BEE NO : 7177



SACHS Ref. : 3100 008 106 - 3151 234 132
RENAULT : 5000821016, 5000677276
BEE NO : 7178



SACHS Ref. : 3151 274 131 - 3151 174 131
RENAULT : 5001 858 682, 5010 244 204
BEE NO : 7179



SACHS Ref. : 3100 000 081 - 3151 150 041
RENAULT : 0001140427, 5000 821 330
BEE NO : 7180



SACHS Ref. : 3151 270 341 - 1897 377 414
RENAULT : 0001151855, 5000436366
BEE NO : 7181

CLUTCH BEARING

SACHS Ref. : 3151 234 231 - 3100 008 204
 RENAULT : 5000677313
BEE NO : 7182



SACHS Ref. : 3151 250 231
 RENAULT : 5010244202
BEE NO : 7183



SACHS Ref. : 3151 250 231
 RENAULT : 5010244017
BEE NO : 7184



SACHS Ref. : 3151 203 031 - 3151 000 144
 RENAULT : 5001858682, 5001864270
BEE NO : 7185



SACHS Ref. : 3151 274 131 - 3151 274 101
 RENAULT : 5010245921, 5010245457
BEE NO : 7186



SACHS Ref. : 1897 376 558 - 3151 000 285
 RENAULT : 5000 786 263, 5001 830 945
BEE NO : 7187

CLUTCH BEARING



SACHS Ref. : 3151 000 157 - 3151 195 033
RENAULT : 5010 556 025
BEE NO : **7188**



SACHS Ref. : 3151 225 031 - 3151 000 144
RENAULT : 5001858682, 5001864270
BEE NO : **7189**



SACHS Ref. : 3151 278 941
RENAULT : 5010244225
BEE NO : **7190**



SACHS Ref. : 3151 233 231 - 3100 008 233
RENAULT : 5001 825 690, 5000 677 265
BEE NO : **7191**



SACHS Ref. : 3151 262 031
RENAULT : 5010452025, 5010545676
BEE NO : **7192**



SACHS Ref. : 1897 917 615 - 3151 600 544
RENAULT : 5000677197
BEE NO : **7193**

CLUTCH BEARING



SACHS Ref. : 3151 000 157
RENAULT : 5010 452 423
BEE NO : 7194



SACHS Ref. : 3151 263 031
RENAULT : 5001866621, 5010244390
BEE NO : 7195



SACHS Ref. : 3151 000 493
RENAULT : 7485127008
BEE NO : 7196



SACHS Ref. : 3100 008 101 - 3100 008 001
SCANIA : 1545062,1321255,107430
BEE NO : 7197



SACHS Ref. : 3182 006 131 - 3182 009 936
SCANIA : 1393332, 1522377, 1123296
BEE NO : 7198



SACHS Ref. : 304311
SCANIA :
BEE NO : 7199

CLUTCH BEARING



SACHS Ref. : 343151000111-343151000 185
SCANIA : 1851631, 1499770, 1728165
BEE NO : 7200



SACHS Ref. :
SCANIA : 1367604
BEE NO : 7201



SACHS Ref. :
SCANIA : 354863, 342833, 304305
BEE NO : 7202



SACHS Ref. : 3100 007 203, 3100 007 001
SCANIA : 1393163, 1321260, 139363
BEE NO : 7203



SACHS Ref. : 3151 105 141 - 3151 105 041
VOLVO : 8112139, 8112138, 267158
BEE NO : 7204



SACHS Ref. : 3151 105 141 - 3151 105 041
VOLVO : 348842, 267158, 1527695
BEE NO : 7205

CLUTCH BEARING



SACHS Ref. : 3151 106 041

VOLVO : 8112168, 8112174, 1527693

BEE NO : 7206



SACHS Ref. : 3100 002 112 - 3100 002 118

VOLVO : 8112159, 1672946, 1668923

BEE NO : 7207



SACHS Ref. : 3151 164 533 - 3151 276 031

VOLVO : 20569174, 3192217, 1672847

BEE NO : 7208



SACHS Ref. : 3100 002 114 - 3483 026 432

VOLVO : 8112113A, 3192222, 1672944

BEE NO : 7209



SACHS Ref. : 3151 000 154 - 3151 167 432

VOLVO : 1672945, 20569159, 3192219

BEE NO : 7210



SACHS Ref. : 3100 002 218 - 3100 026 433

VOLVO : 20571928, 1672946, 8112159

BEE NO : 7211

CLUTCH BEARING



SACHS Ref. : 3151 164 533 - 3151 276 031

VOLVO : 20569174, 3192217, 1672847

BEE NO : 7212



SACHS Ref. : 3100 002 247 - 3100 026 432

VOLVO : 3192222, 1672944, 1668921

BEE NO : 7213



SACHS Ref. : 3151 167 432 - 3151 000 167

VOLVO : 1672945, 3192219, 20569159

BEE NO : 7214



SACHS Ref. : 3100 002 452 - 3100 002 552

VOLVO : 20366913

BEE NO : 7215



SACHS Ref. : 3151 164 534 - 3151 278 131

VOLVO : 3192227, 1672951, 1669912

BEE NO : 7216



SACHS Ref. : 3100 002 449 - 3151 232 331

VOLVO : 3192225, 1668930, 20366912

BEE NO : 7217

CLUTCH BEARING



SACHS Ref. : 3151 000 218 - 3100 002 550
VOVLO : 1668931, 20366912, 3192224
BEE NO : 7218



SACHS Ref. : 3100 002 464 - 3100 026 531
VOLVO : 3192220, 3192221, 20569155
BEE NO : 7219



SACHS Ref. : 3151 270 032 - 3151 000 217
VOLVO : 3192220, 20569155, 20569161
BEE NO : 7220



SACHS Ref. : 3100 002 459 - 3100 026 434
VOLVO : 20569153
BEE NO : 7221



SACHS Ref. : 3100 002 459 - 3100 026 434
VOLVO : 20569153
BEE NO : 7222



SACHS Ref. : 3100 026 431 - 3100 002 460
VOLVO : 20569151 - 20569157
BEE NO : 7223

CLUTCH BEARING



SACHS Ref. : 3151 276 931, 3151 000 154
 VOLVO : 3192219, 20569159,1668922
BEE NO : 7224



SACHS Ref. : 3151 600 533 - 3151 824 002
 VOLVO : 1625288
BEE NO : 7225



SACHS Ref. : 3151 600 534 - 3151 824 003
 VOLVO : 1655287
BEE NO : 7226



SACHS Ref. : 3151 600 535 - 3151 824 004
 VOLVO : 6797058
BEE NO : 7227



SACHS Ref. : 3100 002 459 - 3100 026 434
 VOLVO : 3192216, 20569153
BEE NO : 7228



SACHS Ref. : 3100 002 425 - 3100 002 552
 VOLVO : 20366913
BEE NO : 7229

BEARING



30207	30314 A	32024	32307	33022	BTH-0018	212047/11	211749/10	37425/37625
30208	30314 B	32207	32308	33024	BTH-0022	212049/11	218248/10	3782/20
30209	30314 M	32208	32309	33111	TB 1011	225749/10	4T 2780/29	31594/20
30210	30315	32209	32310	33112	JP 13049/10	25577/23	4T 2788/29	3198
30211 U	31308	32210	32311 A	33113	JP 14049/10	25580/20	4T-2984/24	3984/20
30212	31312-L	32211	32311 B	33115	14118/14276D	29585/20	539/32	NUP-311
30213	31313 A	32212	32312	33116	102949/10	29586/22	565/62	NUP-314
30215	31314	NJ-2018	32313 BA	33117	104948/10	29590/22	HM-215249/10	LL-319349/10
30216	32010	NJ-215	32314-A	33118	12649/10	29685/20	F- 2327504	3386/25
30217	32012	32213	32314 B	33207	18690/20	25590/20	HH 224335/10	33275/62
30219	32013	32214	3307	33208	1988/22	25590/23	HH 228349/10	3982/20
30220	32014	32215	33011	33210	BTH-1011	25590/22	L-217849/10	3975/26
30221	32015	32216	33013	33213	JP-10049/10	25877/23	HM 212046/11	33895/22
30305	32016	32217	33014	33214	TB-1006	26884/23	204043/10	4T 3780/20
30307	32017	32218	33015	33215	BT1-0097 C	27687/20	LM 236749/10	3872/20
30308	32018	32219	33016	33216	TB-1011	27695/20	32920	39581/20
30309	32019	32220	33018	482/472	11162/11300	28680/22	32922	39590/20
30311 A	32020	32221	33019	LM-451349/10	14138/276	28682/22	32924	368A/363D
30311 M	32021	32222	33020	33217	220149	28985/20	32926	386A/82A
30312	32022	32224	33021	33220	212044/11	28985/21	3585/25	387AS/382

BEARING



387A/384D	804356	566425 F. KITT	575725	566/63	636011	748S/42	805165	805011C
388A/382A	805051	566426 F. KITT	539090	580/616	683/72	766/773D	82550/931	805015
390/394-A	455/453A	566427 F. KITT	538971	6379/20	685/72	JW-7049/10	805923	805092C
390A/394AB	480/472	581079 F. KITT	534565	6386/20	687/72	JW-7549/10	803750 B	88048/10
392/394-A	47487/20	566425	528983	6454/20	JM 612949/10	4T-JLM-714149/10	806649	HM-807040/10
395/394-A	47490/20	566426	501349/14	6460/20	JW 6049/10	NP-724254	805165 F. KITT	HM-807046/10
399 AS/394-A	HH-421246	566427	57414	6461 A/20	718149/10	JLM-710949/10 C	JW-8549/10	807048/10
407232	N-407 FORCLIP	581079	50 KW/3720	6464/20	740/42	JM 716649/10	819349/10	803194
45280/20	N-409 FORCLIP	518445	594/92A	65237	759/52	HM714249/10	813843	804358
47890/20	53178	522380	598A/92A	663/53	JHM-720249/10	805052	JLM 813049/10	90381/744
48290	5395/35	524213	527/22	67048/10	78215 C/78551	805165	F-801794/02	98350/98788
462/53	546439	524850	529X/22	68462/712	78225 C/78551	805531	F-805937	98400/98789 D
48548	JM-515649/10	524851	535/32	603049/11	78250/78551	805531	HM-804840/10	903249
415647/10	522649/10	528946	537/32	JF 6549/10	795/92	807049/10	HM-804846/10	JW-9549/10
414/418	55200C/437	529065	BT2B 441026/Q	67388/20	799/92	88540	JW-8049/10	JF-9549/10
45285/20	55206	543805	BTF-0056 HUB	67388/22	766/752	88542	M-84249/10	JT 9049/10
4595/35	LM- 522549/10	543562	BT1 0163 Q	67390/20	JF-7049/10	88547	801400 A	JXC 25381 CE
46780/20	LM-522549/10 D	567171	568/63	67391	749A/42	800308	801464 B	JXC 25690 CA
NA 4924	JHM 534149/10	567549	575/72	DU 60108	749/42A	805046	802048/11	BC1B 320308 A
800792	501349/10	572813	580/72	JV 549/10	7485/42	805415	803146/10	BC1B 326120/HB

HUB CAP



- 03.212.24.25.0 **BEE NO : 7230**
- 03.212.26.14.0 **BEE NO : 7231**
- 03.212.25.08.0 **BEE NO : 7232**
- 03.212.23.09.0 **BEE NO : 7233**
- 03.212.23.02.0 **BEE NO : 7234**
- 03.212.24.07.0 **BEE NO : 7235**
- 03.212.23.01.0 **BEE NO : 7236**
- 03.212.27.01.0 **BEE NO : 7237**
- 03.212.07.01.0 **BEE NO : 7238**
- 03.212.25.31.0 **BEE NO : 7239**
- 212 24 673 **BEE NO : 7240**
- 212 20 727 **BEE NO : 7241**
- 212 23 112 **BEE NO : 7242**
- 212 26 038 **BEE NO : 7243**
- 212 26 119 **BEE NO : 7244**
- AJA-0492-001 **BEE NO : 7245**
- AJA-0492-001 S **BEE NO : 7246**

OIL SEAL



- 104.7x152.4x28.5 **BEE NO : 7247**
100 Teeth
- 104.7x152.4x28.5 **BEE NO : 7248**
80 Teeth
- 2122018 **BEE NO : 7249**
- 0256645700 **BEE NO : 7250**
- 0256645800 **BEE NO : 7251**
- 0256644657 **BEE NO : 7252**
- 0256642657 **BEE NO : 7253**
- 0256646800 **BEE NO : 7254**
- 0256646457 **BEE NO : 7255**
- 21200321A **BEE NO : 7256**
- 21200321B **BEE NO : 7257**
- 2102066 **BEE NO : 7258**
- 40101061 **BEE NO : 7259**
- 93804576 **BEE NO : 7260**
- 40002630 **BEE NO : 7261**
- 0209970547 **BEE NO : 7262**
- 0069977147 **BEE NO : 7263**
- 0249974847 **BEE NO : 7264**

SEAL RING (BPW)

O.E.M. No.	ID (mm.)	OD (mm.)	Thickness (mm.)	BEE NO :
03.310.97.16.0	ø94	131	2.5	7265
03.310.97.03.0	ø98	ø150	2.5	7266
03.310.97.13.0	ø100	ø134	2.5	7267
03.310.98.07.0	ø100	ø165	2.5	7268
03.310.97.32.0	ø104	ø136	2.5	7269
03.310.97.14.0	ø105	ø141	2.5	7270
03.310.98.06.0	ø105	ø172	2.5	7271
03.310.97.31.0	ø110	ø141	2.5	7272
03.310.97.15.0	ø113	ø155	3.5	7273
03.310.98.14.0	ø118	ø165	3.5	7274
03.310.98.04.0	ø118	ø185	3.5	7275
03.310.97.30.0	ø120	ø157	2.5	7276
03.310.98.13.0	ø123	ø171	3.5	7277
03.310.98.02.0	ø123	ø192	3.5	7278
03.310.38.20.0	ø124	ø181	4	7279
03.310.98.21.0	ø128	ø165	2.5	7280
03.310.38.21.0	ø130	ø186	4	7281
03.310.99.02.0	ø144	ø205	3.5	7282
03.310.99.01.0	ø149	ø212	3.5	7283
03.310.98.24.0	ø145	ø173	10	7284
03.310.97.22.0	ø110	ø144	7	7285
03.310.98.18.0	ø125	ø168	7	7286



DAF



M86 x 2

26.00

115.00

Oem No. 1396548
 OD = 115 mm
 Thick. = 26 mm
 M 86 x 2 mm
 DAF

BEE NO : 7287



M58 x 1.5

26.00

89.00

Oem No. 1396606
 OD = 89 mm
 Thick. = 26 mm
 M 58 x 1.5 mm
 DAF

BEE NO : 7288



M58 x 1.5

25.4

88.5

OD = 88.5 mm
 Thick. = 25.4 mm
 M 58 x 1.5 mm
 DAF

BEE NO : 7289



9.00

119.00

9.95

OD = 119 mm
 ID = 58.5 mm
 Thick. = 9 mm
 DAF

BEE NO : 7290



9.00

119.00

9.95

OD = 119 mm
 ID = 58.5 mm
 Thick. = 9 mm
 DAF

BEE NO : 7291



13.00

122.00

148.00

Oem No. 1805821
 ABS
 OD = 148 mm
 ID = 122 mm
 Thick. = 13 mm
 DAF

BEE NO : 7292



18.00

169.00

212.00

Oem No. 1805824
 ABS
 OD = 212 mm
 ID = 169 mm
 Thick. = 18 mm
 DAF

BEE NO : 7293

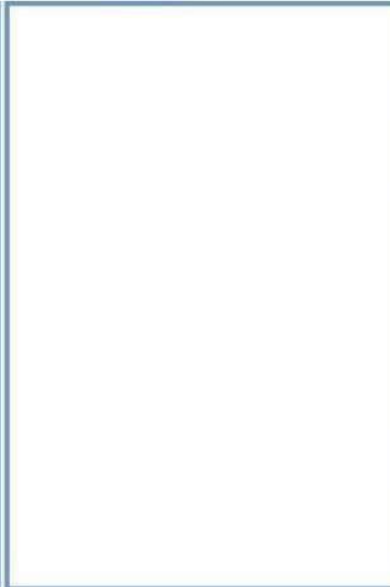

03.262.16.02.0
 Axle Nut
 M 42 x 3
 BPW

BEE NO : 7294



03.262.16.03.0
 Axle Nut
 M 42 x 2
 BPW

BEE NO : 7295



03.262.17.08.0
 Axle Nut
 M 52 x 2
 BPW

BEE NO : 7296



03.262.17.03.0
 03.262.17.11.0
 Axle Nut
 M 60 x 2
 BPW

BEE NO : 7297



BEE OVERSEAS

MOVE WITH PRIDE



116, NOE COROPORATE PLAZA, KANCHPADA, MALAD WEST,

MUMBAI- 400064 MAHARASHTRA, INDIA

CONTACT DETAILS: 91+8080039208/ 91+9819409344

✉ **beeoverseas@yahoo.com**

 [**WWW.beeoverseas.com**](http://WWW.beeoverseas.com)